

**GROUP 600  
ACCESSORIES  
MOD. 632/83**

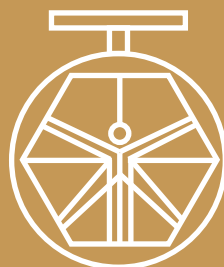

**DAVINCI  
VALVES™**

**TECHNICAL  
DATA SHEET**  
**WATER Series**

**DUCTILE IRON CLAMP**

**DAVINCI  
VALVES™**



**QUALITY  
ASSUREMENT**

**DAVINCI  
VALVES™**



**PRODUCT QT  
ASSUREMENT**

**DAVINCI  
VALVES™**



**COMPANY QT  
ASSUREMENT**

[www.davincivalves.com](http://www.davincivalves.com)

18 Dongyu Street, Square One,  
11th Floor 1101, Jinjiang District,  
Chengdu, Sichuan CHINA

10F/Tower A, Billion Center,  
1 Wang Kwong Road, Kowloon Bay  
Kowloon HONG KONG

## DUCTILE IRON REPAIR CLAMP

**Ref.632A / PN 10-16**

### APPLICATION:

Water, HVAC installations, irrigation, industry, others

### WORKING CONDITIONS:

Working Temperature:

- 10 °C - + 120 °C. for EPDM

- 10 °C - + 82 °C. for NBR



### GENERAL CHARACTERISTICS:

Size DN50 to DN300,

working pressure PN10/PN16

Body pn16

### STANDARDS:

Comply with EN545

### Materials Specification

Sr.No.	Name	Material
1	Body	Ductile Iron
2	Body	Ductile Iron
3	Bridge Plate	SS304
4	Gasket	EPDM/NBR
5,6&7	Tie rods	CS/SS

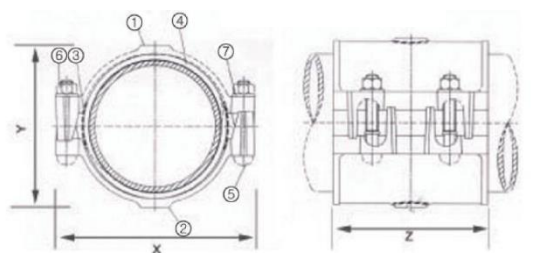

### Dimensions(mm)

DN	50	65	80	100	125	150	175	200	200	225	250	300
Range	66-75	75-84	93-103	115-125	141-153	166-181	200-210	217-226	231-243	243-267	269-294	323-349
x	150	159	184	211	239	267	296	313	328	362	395	450
Y(max)	110	119	145	167	182	217	238	269	281	307	322	387
Z	200	200	200	200	200	200	200	200	200	200	250	300
Outlet threaded	3/4"	3/4"	3/4"	1/2"- 1"	1/2"- 1"	1/2"- 1"	1/2"- 1"	1/2"- 1"	1/2"- 1"	1/2"- 1"	1/2"- 1"	1/2"- 1"

*All the components can be substituted with equivalent or higher-class materials.*

DAVINCI VALVES LTD, is constantly looking at all ways of improving our products and services related to the water, fire and industry sector and therefore we reserve the right to change, without prior notice, any of the data contained here. Please contact our Technical Sales Department for detailed advice.  
© 2018 DAVINCI VALVES LTD.

www.davincivalves.com info@davincivalves.com +34 616553797 / +86 17340168233  
18 Dongyu Street, Square One 11th Floor 1101. Jinjiang District, Chengdu, Sichuan Province, China

*"For professionals who wants more"*

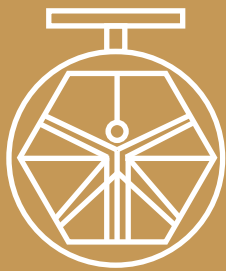

DAVINCI  
VALVES™

[www.davincivalves.com](http://www.davincivalves.com)