

**GROUP 810
KNIFE
VALVES
MOD.810A/104**



**DAVINCI
VALVES™**

**TECHNICAL
DATA SHEET**

INDUSTRY Series

**BIDIRECTIONAL SEALING KNIFE VALVE DISC
THROUGH TYPE**

**DAVINCI
VALVES™**



**QUALITY
ASSUREMENT**

**DAVINCI
VALVES™**



**PRODUCT QT
ASSUREMENT**

**DAVINCI
VALVES™**



**COMPANY QT
ASSUREMENT**

www.davincivalves.com

18 Dongyu Street, Square One,
11th Floor 1101, Jinjiang District,
Chengdu, Sichuan CHINA

10F/Tower A, Billion Center,
1 Wang Kwong Road, Kowloon Bay
Kowloon HONG KONG

BIDIRECTIONAL SEALING KNIFE VALVE DISC THROUGH TYPE

ref.810A / PN 10-16



MODEL: 810A

WORKING PRESSURE:

DN50-DN10 16Bar DN125-DN200 14Bar
DN250-DN300 12Bar DN350-DN400 10Bar

STANDARDS:

Type: Wafer
Design: MSS SP-81
Flange Standard: DIN PN10, PN16, 150LB, JIS 10K, TABLE E/D
Face to Face: MSS SP-81
Testing Standard: API-598
Operation: handwheel, electric, pneumatic, hydraulic, sprocket, electro-hydraulic, gear box

GENERAL CHARACTERISTICS:

Main Material: WCB, CF8M, CF8, F55, F53, 2205, SS310, CF3M, CF3
Wedge Material: SS316L, SS304
Sealing Material: EPDM, NBR, FKM, Metal
Packing: Applicable for coal in power plant, sewage treatment, food, paper making, medicine, petroleum and chemical industry, water, Oil, steam, connecting or cutting grout, gold powder, ores, slag, coal, pulp, wood pulp, tailings, fibers, dust, chemicals, sewage treatment, sedimentation tanks, asphalt, bunker export, cereals, slaughter plant waste and other media.

FEATURES:

- ✚ Bi-directional seal
- ✚ Additional seat design
- ✚ Self-sealing design Suitable for a variety of different conditions
- ✚ 2PC Strong yoke design
- ✚ Cleaning hloe design, easy for cleaning body Residual medium
- ✚ Mixed with a variety of materials packing

PRODUCT DESCRIPTION:

810 Series No groove bi-directional seal knife gate valve, cast iron body with the overall structure knife gate valve, including valve' body, gate, and U-shaped flexible seal at the bottom of the body with grooves. When the valve is closed, the bottom of the gate edge contact with the seal and then compress the seal into the groove in the body and sealed gate realization; when the gate opens, separate gate from the bottom edge of the seal, seal will bounce to same level as groove, which will prevent the media sediment accumulated in the body cavity of the groove, no clogging, no residue, pipe easy to clean, so as to effectively improve the sealing effect knife gate valve to prevent leakage when the valve is closed.

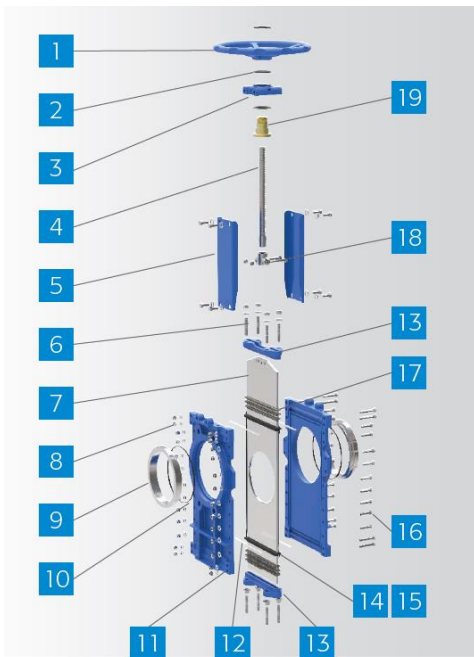

No.	Part	Material	QTY
1	Hand wheel	GGG40	1
2	Bearing	ZChSnSb10-6	2
3	Yoke Flange	GGG40	1
4	Stem	Q235/SS304/SS316	1
5	Yoke	Q235	2
6	Bolt & Nut	SS201/SS304	N
7	Disc	F55.F53. 2205.SS304.SS316	1
8	Nut	Fe+Zn/SS304	N
9	Seat Gland	WCB/SS304/SS316	2
10	Seat	EPDM/NBR/FKM	2
11	Body	F55.F53.CF3M.CF8M.CF8.WCB.GGG40	2
12	Scraper	PTFE	4
13	Packing Gland	WCB/CF8	2
14	Packing	EPDM/NBR/PTFE	2
15	Body Sealing	EPDM/NBR/FKM	2
16	Bolt	Fe+Zn/SS304	N
17	Packing	EPDM/NBR/FKM	3-5
18	Chuck	WCB/SS304/SS316	1
19	Stem Nut	Brass	1

All the components can be substituted with equivalent or higher-class materials.

DAVINCI VALVES LTD, is constantly looking at all ways of improving our products and services related to the water, fire and industry sector and therefore we reserve the right to change, without prior notice, any of the data contained here. Please contact our Technical Sales Department for detailed advice.

© 2018 DAVINCI VALVES LTD.

www.davincivalves.com info@davincivalves.com +34 616553797 / +86 17340168233

BIDIRECTIONAL SEALING KNIFE VALVE DISC THROUGH TYPE

ref.810A / PN 10-16

DIMENSION

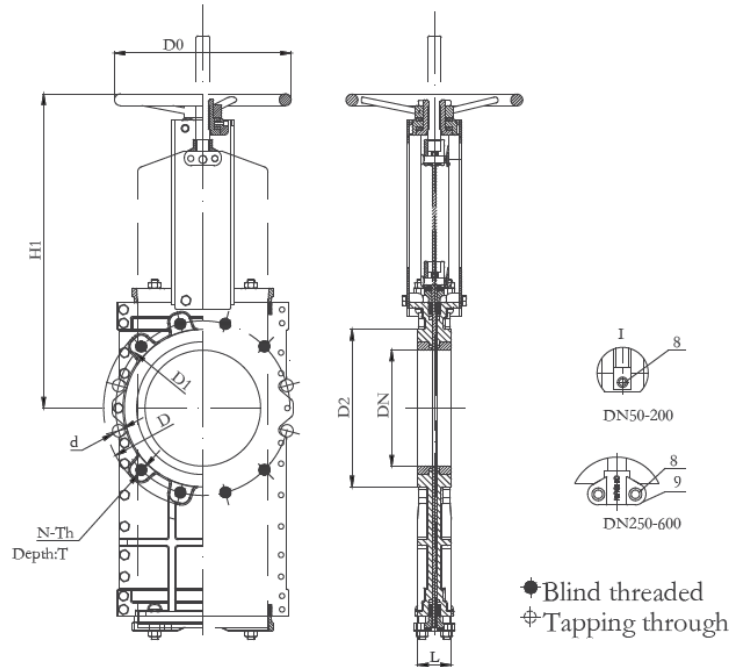

DIN2632 PN10									ANSI 150LB								
DN	L	D	D1	D2	D0	N-Th	d(φ)	H1	DN	L	D	D1	D2	D0	N-Th	d(φ)	H1
50	48	165	125	99	180	4-M16	18	260	2"	48	152	121	92	180	4-5/8"	19	260
65	48	185	145	118	200	4-M16	18	292	2-1/2"	48	178	140	105	200	4-5/8"	19	292
80	51	200	160	132	200	8-M16	18	320	3"	51	191	153	127	200	4-5/8"	19	320
100	51	220	180	156	240	8-M16	18	358	4"	51	229	191	157	240	8-5/8"	19	358
125	57	250	210	184	260	8-M20	18	395	5"	57	254	216	186	260	8-3/4"	22	395
150	57	285	240	211	280	8-M20	23	450	6"	57	279	242	216	280	8-3/4"	22	450
200	70	340	295	266	300	12-M20	23	532	8"	70	343	299	270	300	8-3/4"	22	532
250	70	395	350	319	320	12-M20	23	670	10"	70	406	362	324	320	12-7/8"	25	670
300	76	445	400	370	350	16-M20	23	758	12"	76	483	432	381	350	12-7/8"	25	758
350	76	505	460	429	400	16-M20	23	857	14"	76	533	476	413	400	12-1"	29	857
400	89	565	515	480	450	16-M24	27	946	16"	89	597	540	470	450	16-1"	29	946
450	89	615	565	530	500	20-M24	27	1023	18"	89	635	578	533	500	16-1 1/8"	32	1023
500	114	670	620	582	500	20-M24	27	Gear	20"	114	699	635	584	500	20-1 1/8"	32	Gear

All the components can be substituted with equivalent or higher-class materials.

DAVINCI VALVES LTD, is constantly looking at all ways of improving our products and services related to the water, fire and industry sector and therefore we reserve the right to change, without prior notice, any of the data contained here. Please contact our Technical Sales Department for detailed advice.

© 2018 DAVINCI VALVES LTD.

www.davincivalves.com info@davincivalves.com +34 616553797 / +86 17340168233

BIDIRECTIONAL SEALING KNIFE VALVE DISC THROUGH TYPE

ref.810A / PN 10-16

PN10 Threaded Hole and Tapping Hole

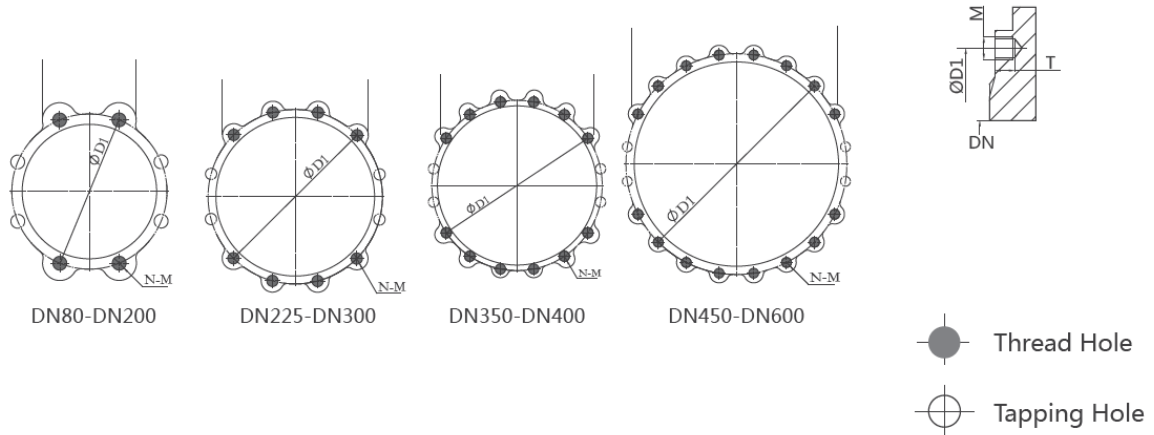

PN10						
DN	D1	N	M	T	Thread Hole	Tapping Hole
80	160	8	16	13	4	4
100	180	8	16	13	4	4
125	210	8	16	16	4	4
150	240	8	16	16	4	4
200	295	8	20	20	4	4
225	310	12	20	20	8	4
250	350	12	20	20	8	4
300	400	12	20	20	8	4
350	460	16	20	20	12	4
400	515	16	24	24	12	4
450	565	20	24	24	16	4
500	620	20	24	24	16	4
550	680	20	27	24	16	4
600	725	20	27	27	16	4

All the components can be substituted with equivalent or higher-class materials.

DAVINCI VALVES LTD, is constantly looking at all ways of improving our products and services related to the water, fire and industry sector and therefore we reserve the right to change, without prior notice, any of the data contained here. Please contact our Technical Sales Department for detailed advice.
 © 2018 DAVINCI VALVES LTD.
 www.davincivalves.com info@davincivalves.com +34 616553797 / +86 17340168233

BIDIRECTIONAL SEALING KNIFE VALVE DISC THROUGH TYPE

ref.810A / PN 10-16

150LB Threaded Hole and Tapping Hole

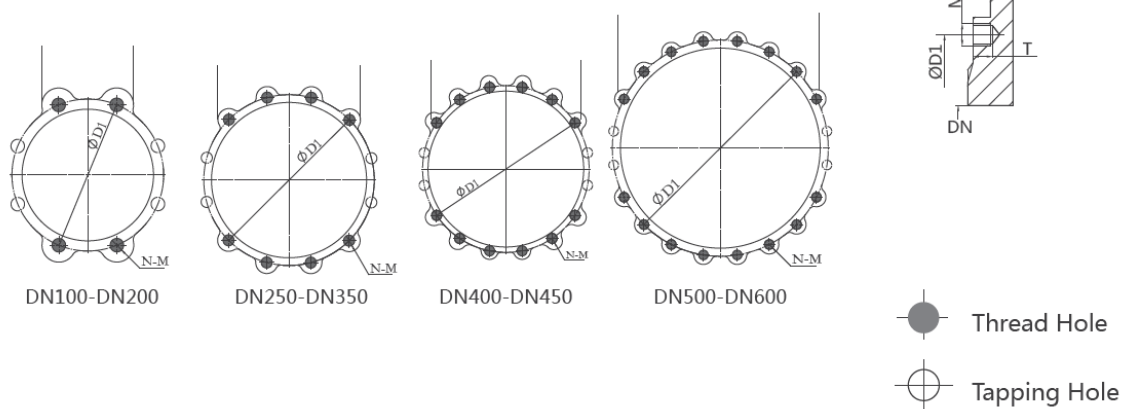

ANSI 150LB						
DN	D1	N	M	T	Thread Hole	Tapping Hole
4"	191	8	M5/8-11	12	4	4
5"	216	8	M3/4-10	12	4	4
6"	242	8	M3/4-10	14	4	4
8"	299	8	M3/4-10	16	4	4
10"	362	12	M7/8-9	16	8	4
12"	432	12	M7/8-9	16	8	4
14"	476	12	M1-8	18	8	4
16"	540	16	M1-8	20	12	4
18"	578	16	M1 1/8-7	20	12	4
20"	635	20	M1 1/8-7	24	16	4
22"	692	20	M1 1/4-7	24	16	4
24"	750	20	M1 1/4-7	27	16	4

All the components can be substituted with equivalent or higher-class materials.

DAVINCI VALVES LTD, is constantly looking at all ways of improving our products and services related to the water, fire and industry sector and therefore we reserve the right to change, without prior notice, any of the data contained here. Please contact our Technical Sales Department for detailed advice.

© 2018 DAVINCI VALVES LTD.

www.davincivalves.com info@davincivalves.com +34 616553797 / +86 17340168233

"For professionals who wants more"

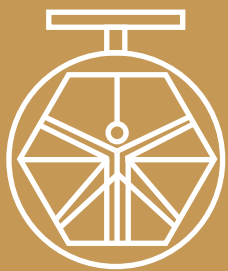

DAVINCI
VALVES™